



WISCO INDUSTRIES, INC.

PHONE: 608.835.3106 • TOLL FREE: 800.999.4726 • FAX: 608.835.8273 • www.wiscoind.com

MODEL 780 – FRONT DOOR REPLACEMENT

0021438SK

DESCRIPTION

This document illustrates how to replace a front door on a Model 780.

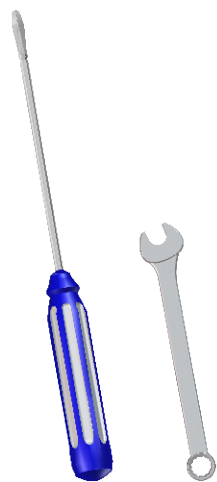

TOOLS NEEDED

- #2 Phillips Screwdriver
- $\frac{5}{16}$ " Wrench

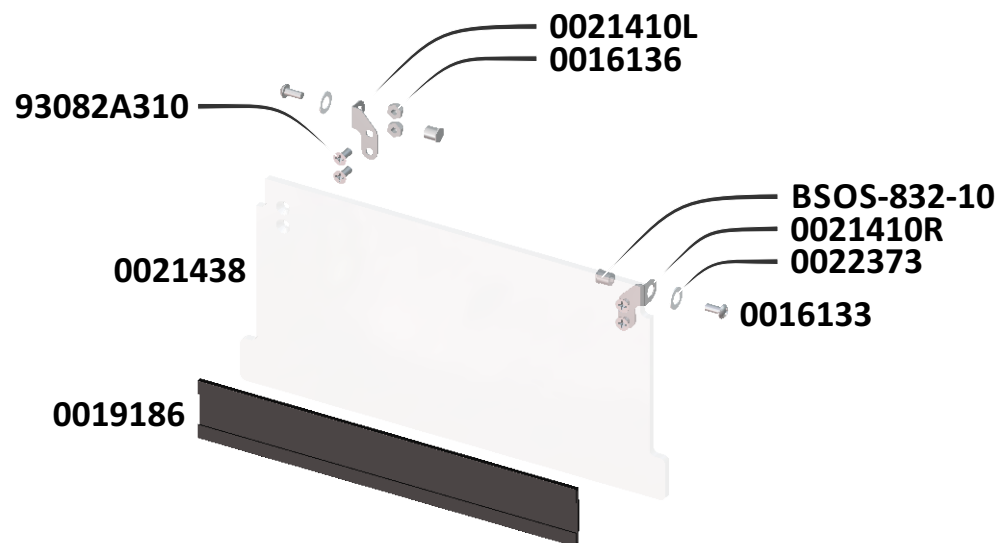

PARTS INCLUDED

- (4) 93082A310 #8-32 $\frac{3}{8}$ " FLAT HEAD MACHINE SCREW
- (1) 0021438 FRONT DOOR
- (1) 0019186 1- $\frac{1}{4}$ " C-CHANNEL
- (1) 0021410L DOOR HINGE (LEFT)
- (4) 0016136 #8-32 ACORN NUT
- (2) BSOS-832-10 #8-32 BLIND STANDOFF
- (1) 0021410R DOOR HINGE (RIGHT)
- (2) 0022373 WASHER
- (2) 0016133 #8-32 x $\frac{3}{8}$ " PAN HEAD MACHINE SCREW

Please review this document thoroughly before beginning repairs. Wisco recommends using qualified local service agents. Wisco does not have authorized service agents.



WISCO INDUSTRIES, INC.

PHONE: 608.835.3106 • TOLL FREE: 800.999.4726 • FAX: 608.835.8273 • www.wiscoind.com

MODEL 780 – FRONT DOOR REPLACEMENT

0021438SK



UNPLUG UNIT FROM OUTLET AND ALLOW TO COOL

- 1** Remove rack(s) to increase working space (optional)

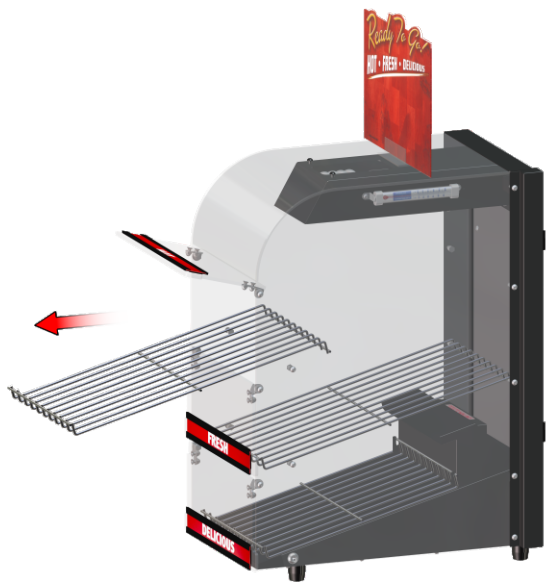

- 2** Use #2 Phillips Screwdriver and $\frac{5}{16}$ " Wrench to remove any remaining door hardware

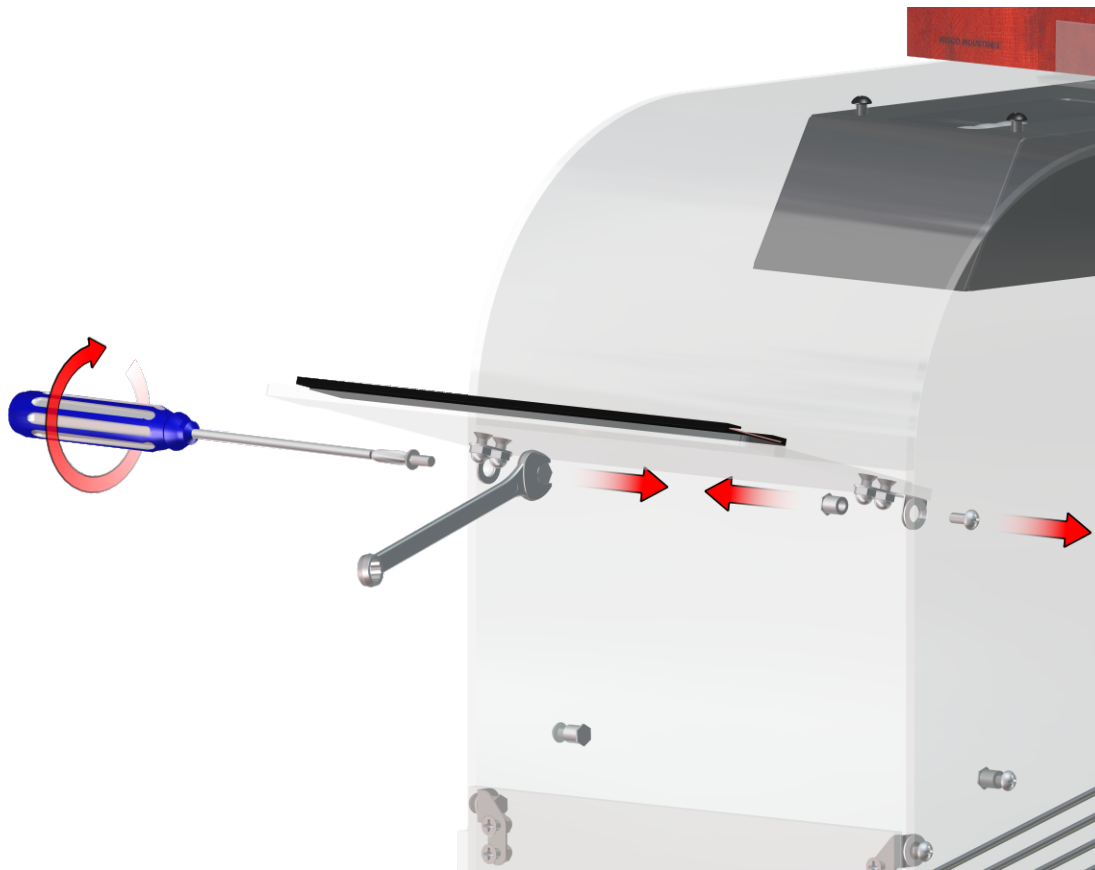



WISCO INDUSTRIES, INC.

PHONE: 608.835.3106 • TOLL FREE: 800.999.4726 • FAX: 608.835.8273 • www.wiscoind.com

MODEL 780 – FRONT DOOR REPLACEMENT 0021438SK

- 3**
- Remove door and washers
 - Save C-Channel Graphic

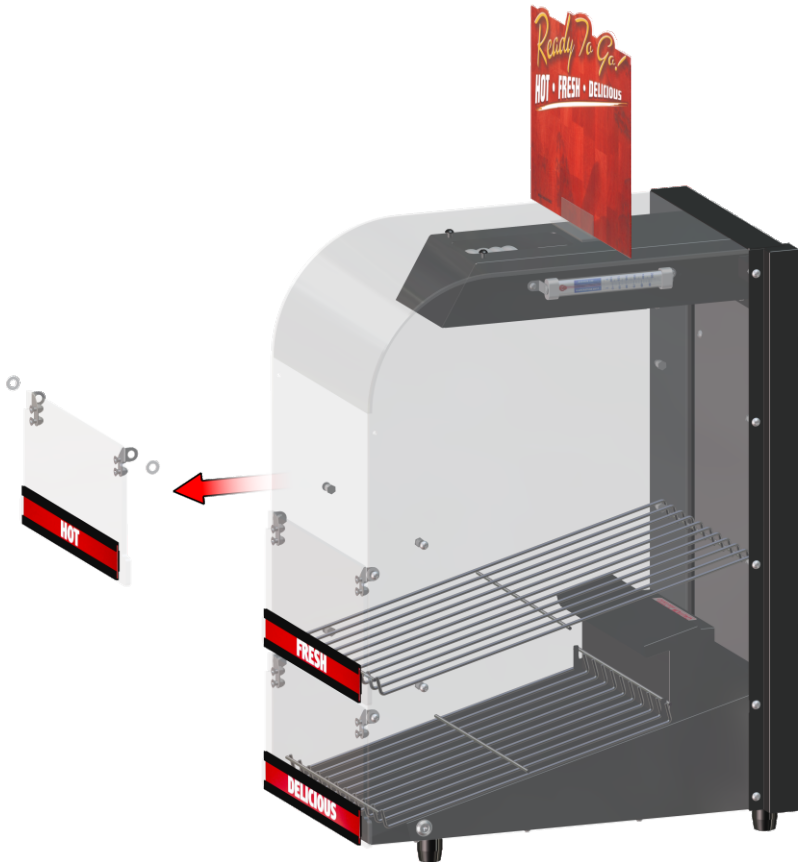

- 4**
- Align new door





WISCO INDUSTRIES, INC.

PHONE: 608.835.3106 • TOLL FREE: 800.999.4726 • FAX: 608.835.8273 • www.wiscoind.com

MODEL 780 – FRONT DOOR REPLACEMENT

0021438SK

- 5** Install new door with new hardware as shown below

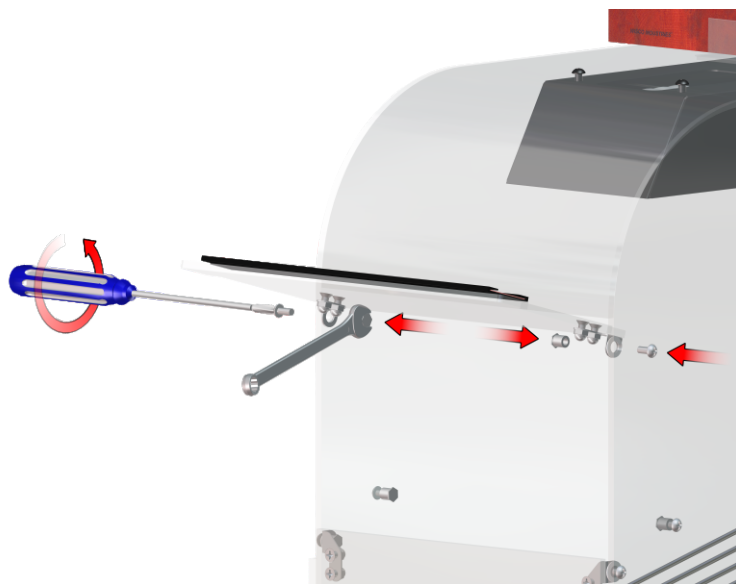

FRONT VIEW - LEFT SIDE

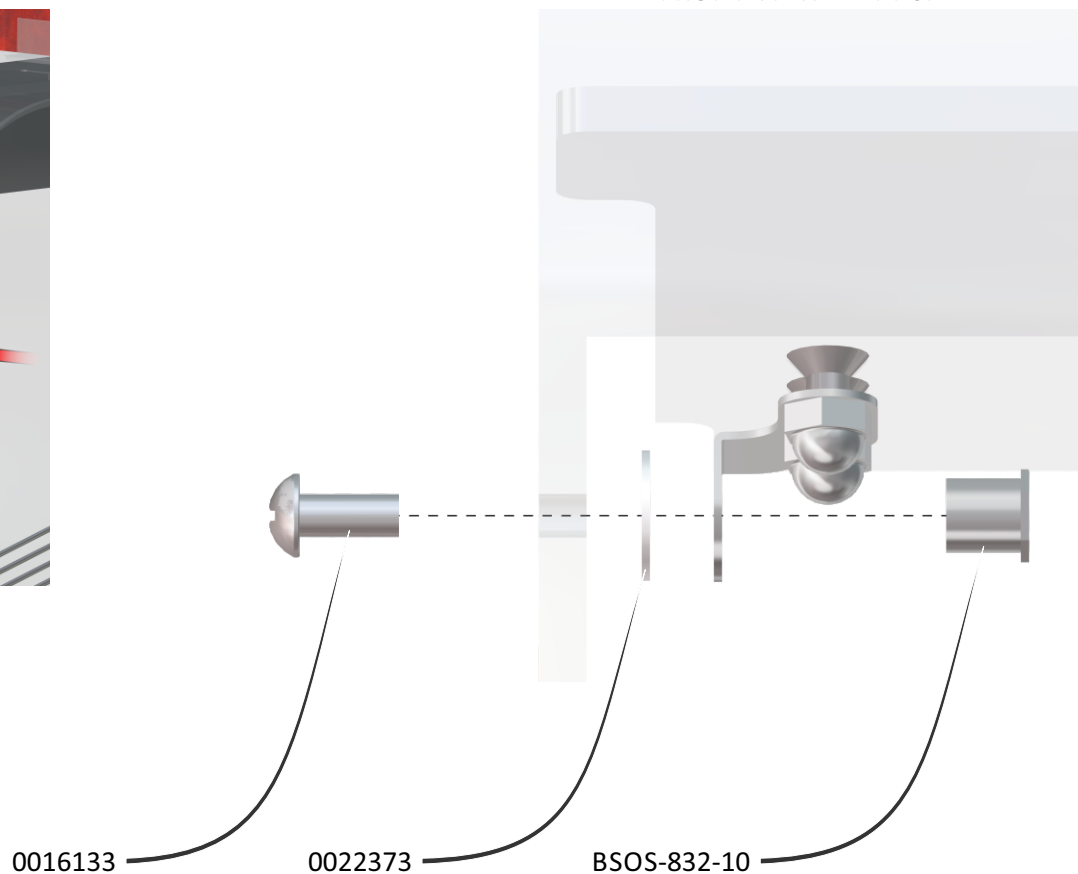

ENSURE THAT THE BLIND STANDOFF IS FREELY THROUGH THE WASHER



WISCO INDUSTRIES, INC.

PHONE: 608.835.3106 • TOLL FREE: 800.999.4726 • FAX: 608.835.8273 • www.wiscoind.com

MODEL 780 – FRONT DOOR REPLACEMENT 0021438SK

6 Remove any protective plastic from new door

7 Apply new C-Channel to new door



8 Replace any Racks and C-Channel Graphics

9 Unit is now ready for operation