

1.200 MAX

9.000 MAX

0.216

0.266

NOTE:
CROSSHATCHING COVERED BY COMPONENTS
MAXIMUM MATERIAL THICKNESS 0.020"

L:\Eng\SolidWorks\Wisco Decal Requirements Templates\W473A 780 787 C-Channel Template\Rev Original\

UNLESS OTHERWISE SPECIFIED:

TOLERANCES ARE IN INCHES
FRACTIONAL $\pm 1/64$
ANGULAR: ± 1
ONE PLACE DECIMAL $\pm .030$
TWO PLACE DECIMAL $\pm .020$
THREE PLACE DECIMAL $\pm .010$
FOUR PLACE DECIMAL $\pm .005$

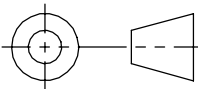

DO NOT SCALE DRAWING



WISCO INDUSTRIES, INC.
955 MARKET ST.
OREGON, WI 53575
www.wiscoind.com

PART DESCRIPTION
780 787 C-CHANNEL TEMPLATE

PART NUMBER
W473A

MATERIAL

FINISH

SCALE: 1:1

SHEET 1 OF 1

ORIG	ORIGINAL DESIGN	5/8/2014	GLS
REV.	DESCRIPTION	DATE	APPROVED